

COLLECTION

Nasopharyngeal (NP) Swab

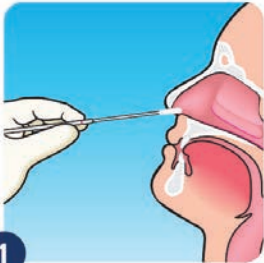

- 1
- Remove swab from packaging.
 - Position head slightly back.



- 2
- Insert a swab into nostril parallel to the palate.
 - Swab should reach depth equal to distance from nostrils to outer opening of the ear.



- 3
- Leave swab in place for several seconds to absorb secretions.
 - Slowly remove swab while rotating it.

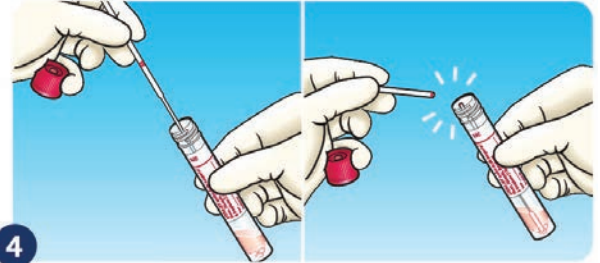

- 4
- While holding swab, remove cap from transport media.
 - Insert swab until the breakpoint is level with tube opening.
 - Bend the swab shaft at a 180° angle to break it off at the breakpoint.
 - Secure cap back onto transport media and apply patient identification label.

COLLECTION

Anterior Nares Swab* BD BBL™ CultureSwab® EZ



- 1
- Remove swab from plastic sheath.
 - DISCARD** plastic sheath.

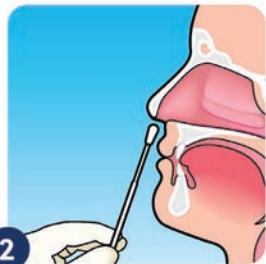

- 2
- Position head slightly back.
 - Insert swab into **LEFT** nostril.
 - Gently push swab until slight resistance is met (less than 1" into nostril).



- 3
- Rotate swab in a circular motion for 3-5 seconds.
 - Remove swab from **LEFT** nostril.
 - Repeat steps on **RIGHT** nostril.
 - Remove swab when finished.

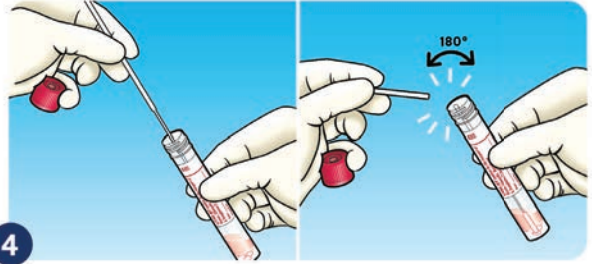

- 4
- While holding swab, remove cap from transport media.
 - Insert swab 3/4 into tube.
 - Bend swab shaft at a 180° angle against side of tube; bend back and forth until top of swab breaks off, or cut.
 - Discard top of swab.
 - Secure cap back onto transport media and apply patient identification label.

SHIPPING

- Package **one patient per bag** only.
- Ship in a separate biohazard bag with refrigerated (2-8° C) Ascend specimens.
- For clinics who utilize a local courier, place with your refrigerated Ascend specimens for pickup.
- For clinics who utilize Ascend shipping boxes, ship with your refrigerated Ascend specimens, and place a UN3373 sticker on the Ascend specimen shipping box.

If you have any questions, please contact Client Services at 800.800.5655, Option 1.